

#11380

Assembly Instructions
Instructions d'assemblage
Instrucciones para el ensamblaje

If you have any questions about this product, or are missing a part, please call us toll-free at 1-800-521-7080 or visit our website rather than return this product to the store.

Si vous avez des questions sur ce produit ou que des pièces manquent, veuillez nous appeler sans frais au 1-800-521-7080 ou visiter notre site Web au lieu de renvoyer le produit au magasin.

Si tiene alguna pregunta sobre este producto o se le ha perdido una pieza, por favor llámenos al número gratuito 1-800-521-7080 o visite nuestro sitio web, en lugar de devolverlo a la tienda.

M-F 7:30 - 4:30 EST www.americanplastictoys.com

799 Ladd Rd.
Walled Lake, MI 48390

ADULT ASSEMBLY REQUIRED. Tools needed:
clippers (not included).
L'ASSEMBLAGE NÉCESSITE UN ADULTE. Outils requis:
ciseaux (non inclus).
REQUIERE MONTAJE POR UN ADULTO. Herramientas
necesarias: alicates (no se incluye).

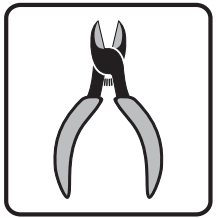

KEEP SMALL PARTS, HARDWARE, AND PLASTIC BAGS
OUT OF CHILDREN'S REACH.
Toys in contact with food must be washed thoroughly before use.

TOUTES LES PETITES PIÈCES, LA QUINCAILLERIE ET LES SACHETS EN MATIÈRE
PLASTIQUE DOIVENT ÊTRE GARDÉS HORS DE PORTÉE DES ENFANTS.
Les jouets en contact avec de la nourriture doivent être lavés à fond avant usage.

MANTENER LAS PIEZAS PEQUEÑAS, FERRETERÍA Y BOLSAS DE PLÁSTICO
FUERA DEL ALCANCE DE LOS NIÑOS.
Los juguetes en contacto con la comida deben ser lavados
con cuidado antes del uso.

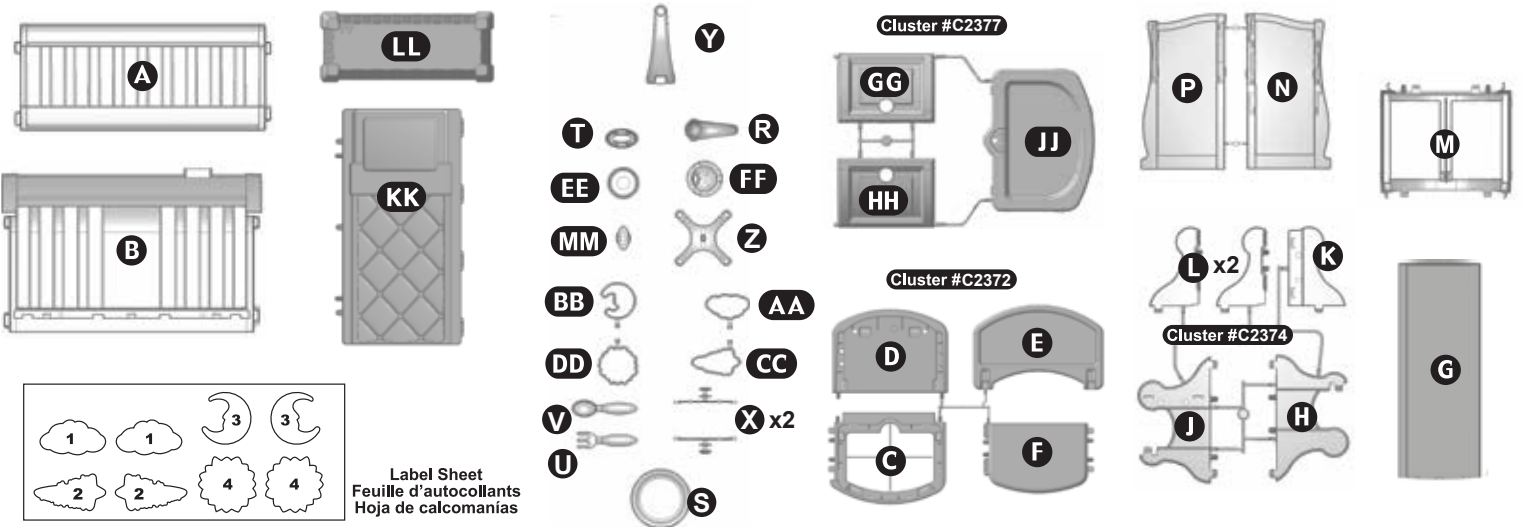

Label Sheet
Feuille d'autocollants
Hoja de calcomanías

VERY IMPORTANT!
TRÈS IMPORTANT!
¡MUY IMPORTANTE!

Carefully trim all tie bands before assembly.
Découper délicatement toutes les bandes
d'attache avant l'assemblage.
Corte todas las cintas de amarre con cuidado
antes del montaje.

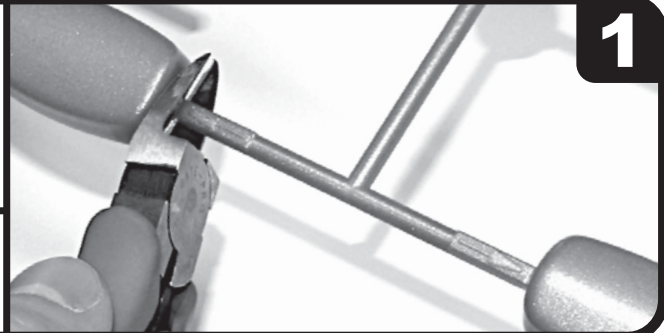

→ = snap / emboîter / cerrar a presión

2 Clip all cluster parts.
Détachez toutes les pièces de la grappe.
Separe todas las piezas del grupo.

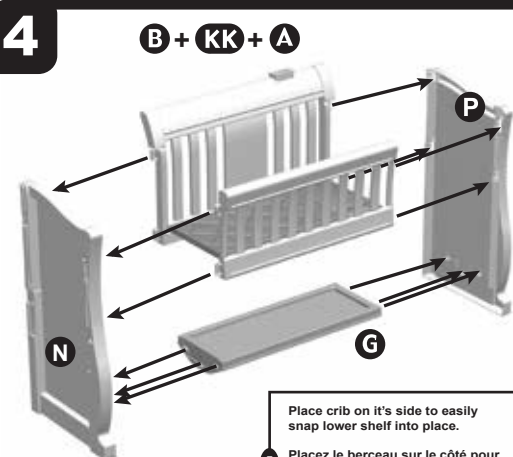
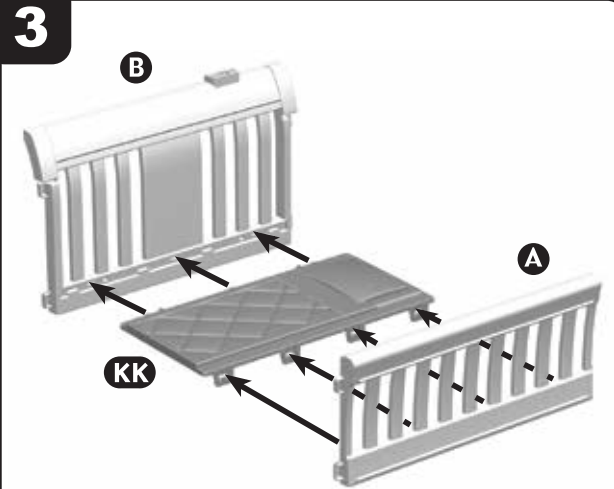

Place crib on it's side to easily
snap lower shelf into place.
Placez le berceau sur le côté pour
insérer facilement l'étagère inférieure
en place.
Coloque la cuna de lado para insertar
fácilmente el estante inferior en su lugar.

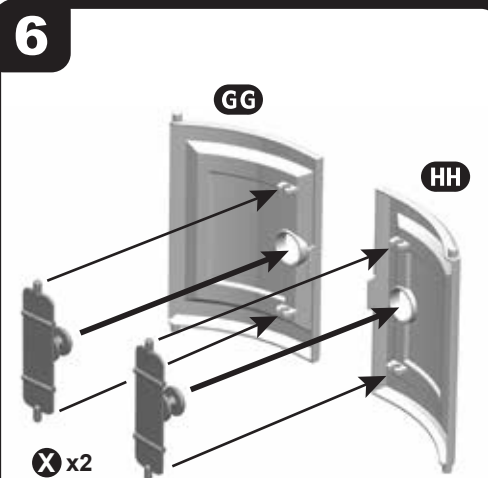
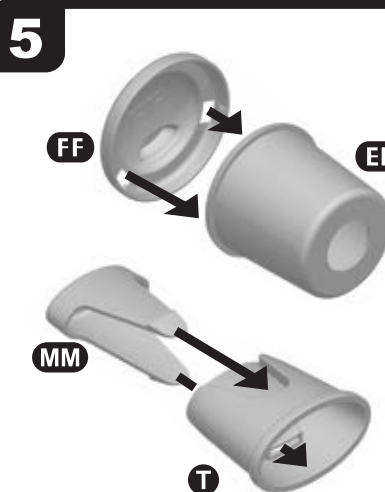

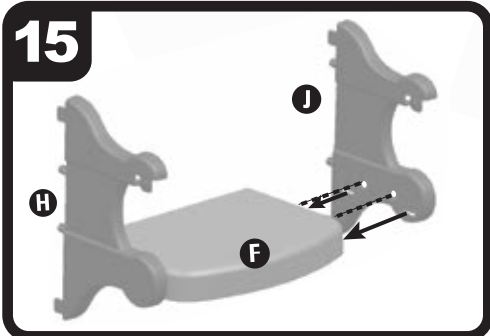
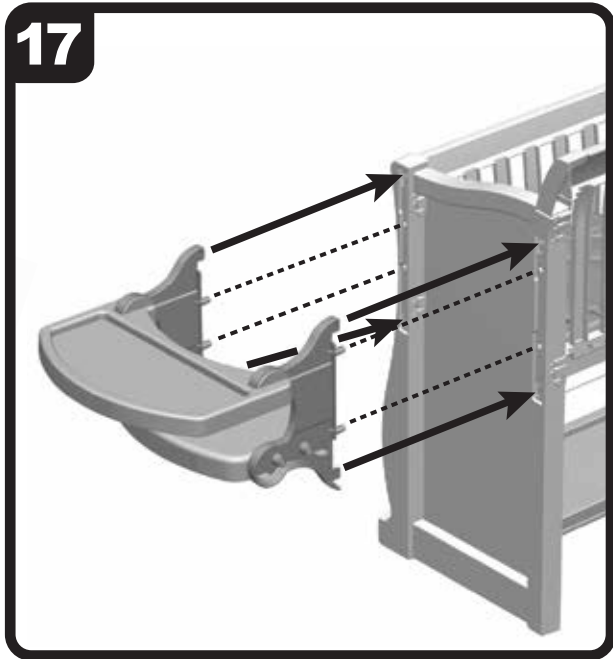
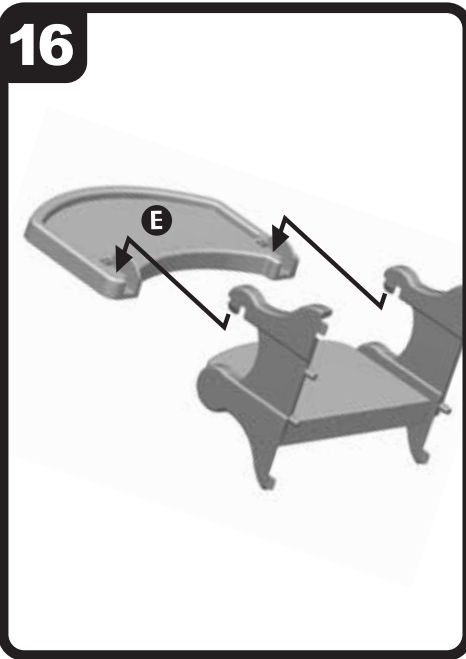
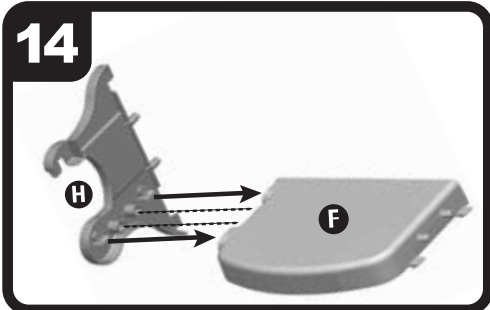
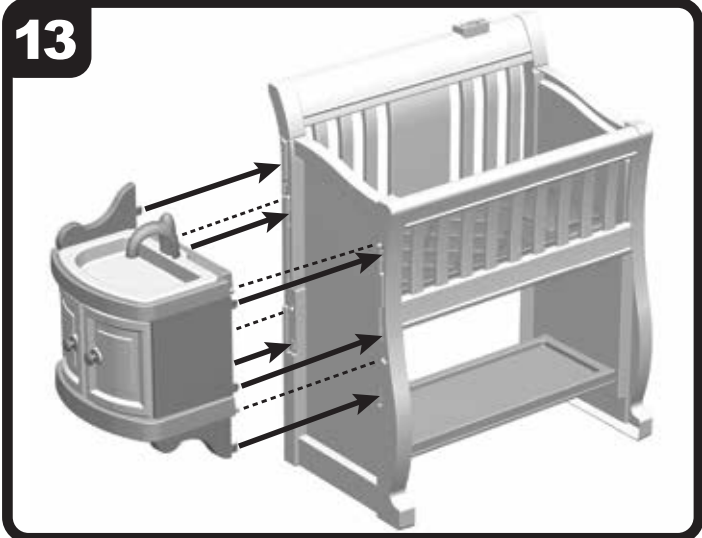
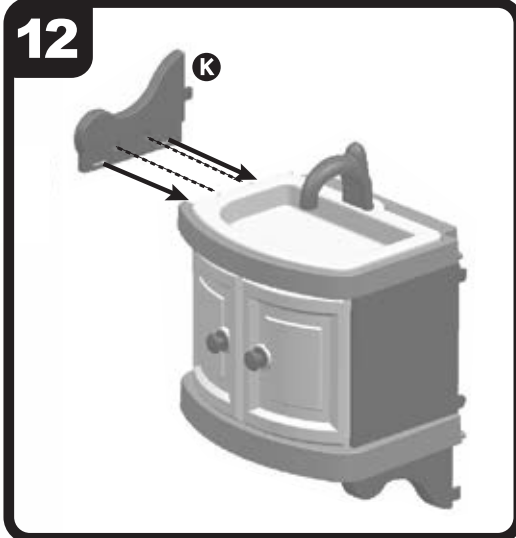
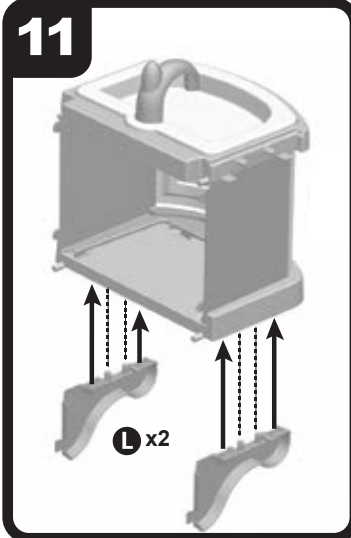
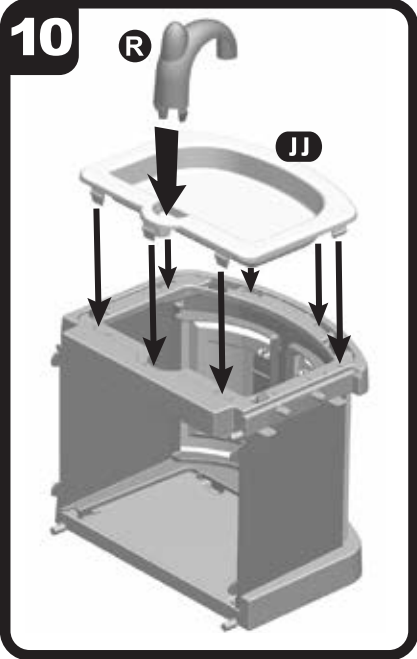
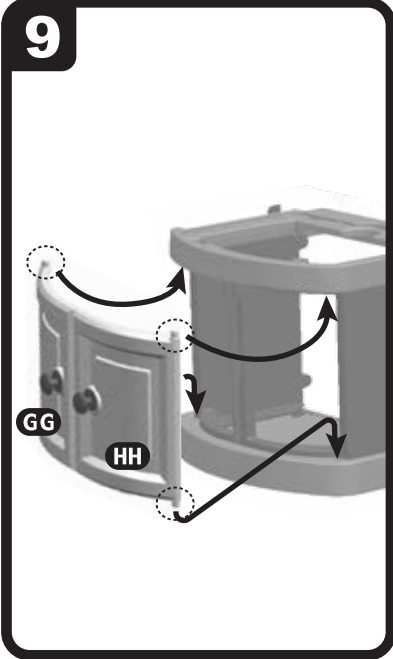
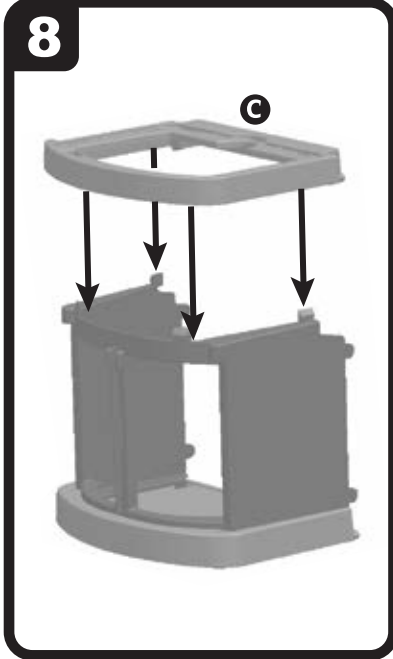
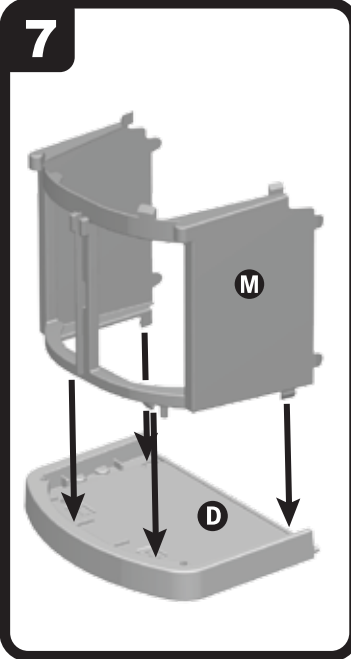

18

Label Sheet
Feuille d'autocollants
Hoja de calcomanías

Diagram showing the application of stickers **AA**, **BB**, **CC**, **DD**, and **YY** to the faucet assembly **Z**. Arrows indicate the stickers being placed on the faucet.

Apply labels as shown.
Appliquer les autocollants tel qu'illustré.
Coloque las calcomanías de la forma ilustrada.

